

BL1.6/25-11

Specifications

Focal Length	25mm	Mount	C-Mount
Image Circle	11mm	MaxD	Φ30.6
Max. F#	F1.6	Filter	M27×0.5
Magnification	0.0X-0.2X	Σd	31.26mm
Spectrum	420nm - 680nm		
Working Distance	∞ -100mm		
Resolution	3.45 μm		

Mechanical Drawing

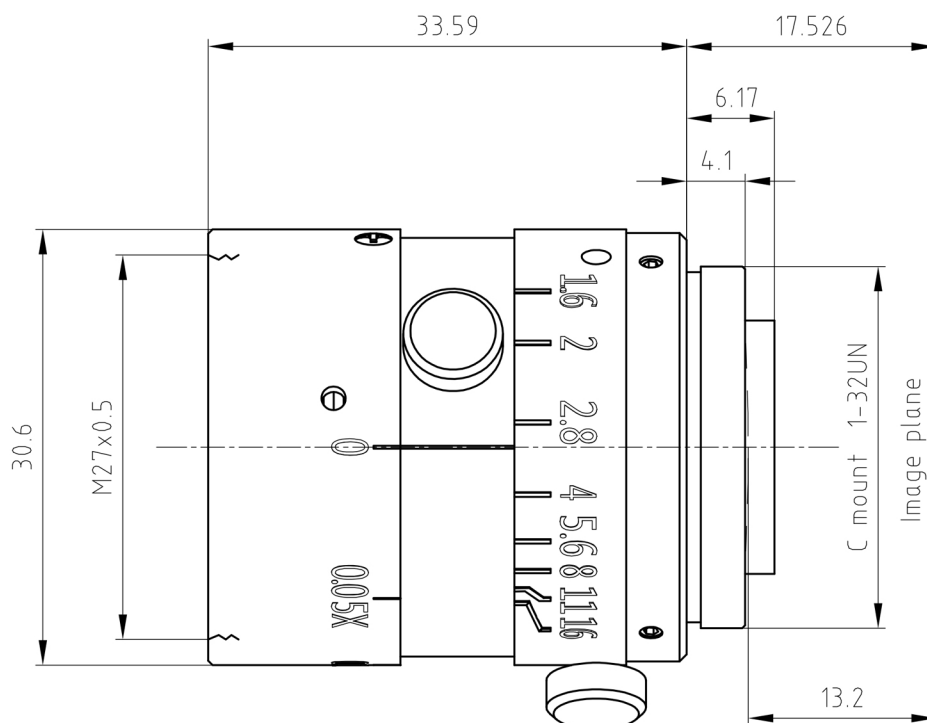

Distortion

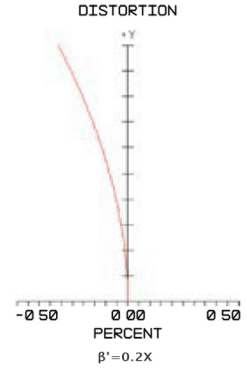
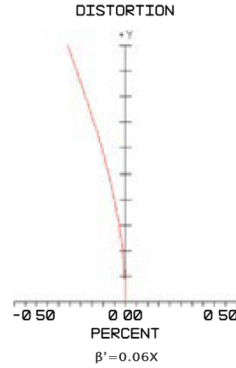
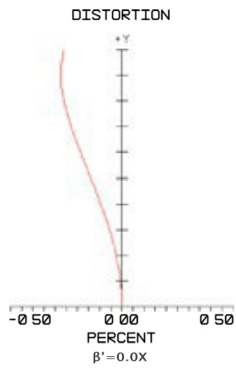

Modulation to Relative Image Height

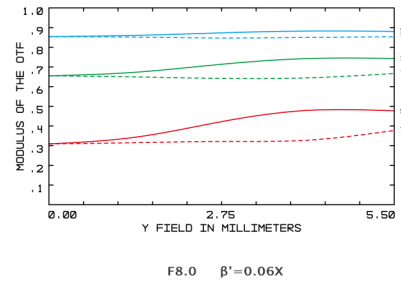
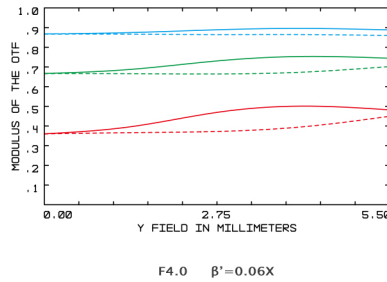
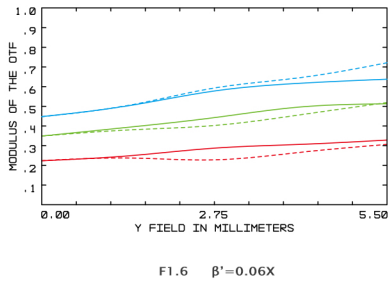

Relative Illumination

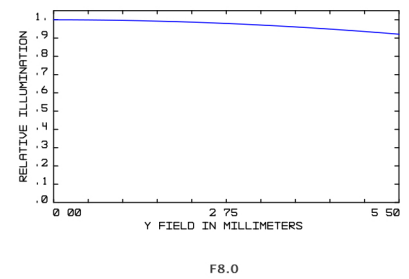
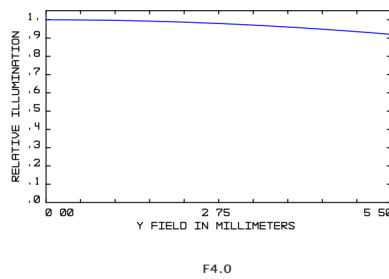
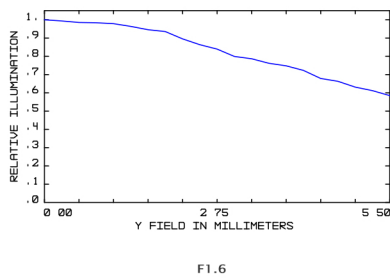

Transmittance

